

Telehealth – How to Connect to your Healthcare Provider

Android Device

Open the internet using the Google Chrome app

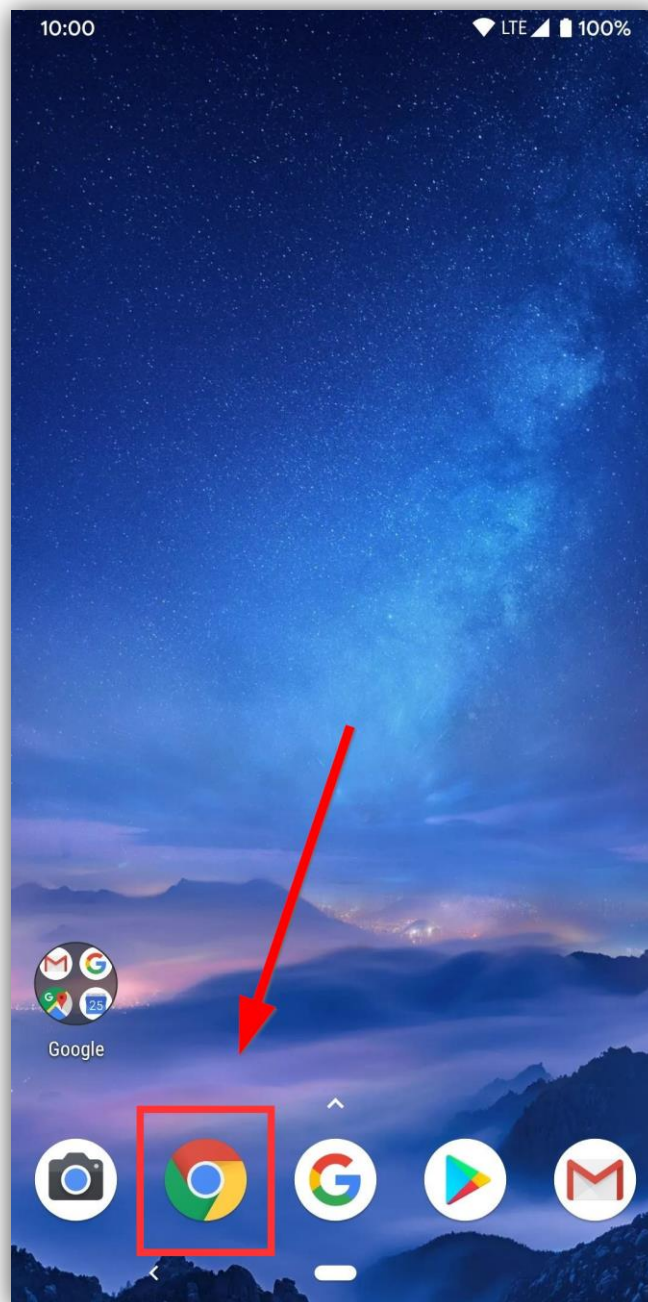

Go to the address given to you by the office.

The website will ask you for your name. You will then be asked to enable your camera. Press **'Enable Camera.'**

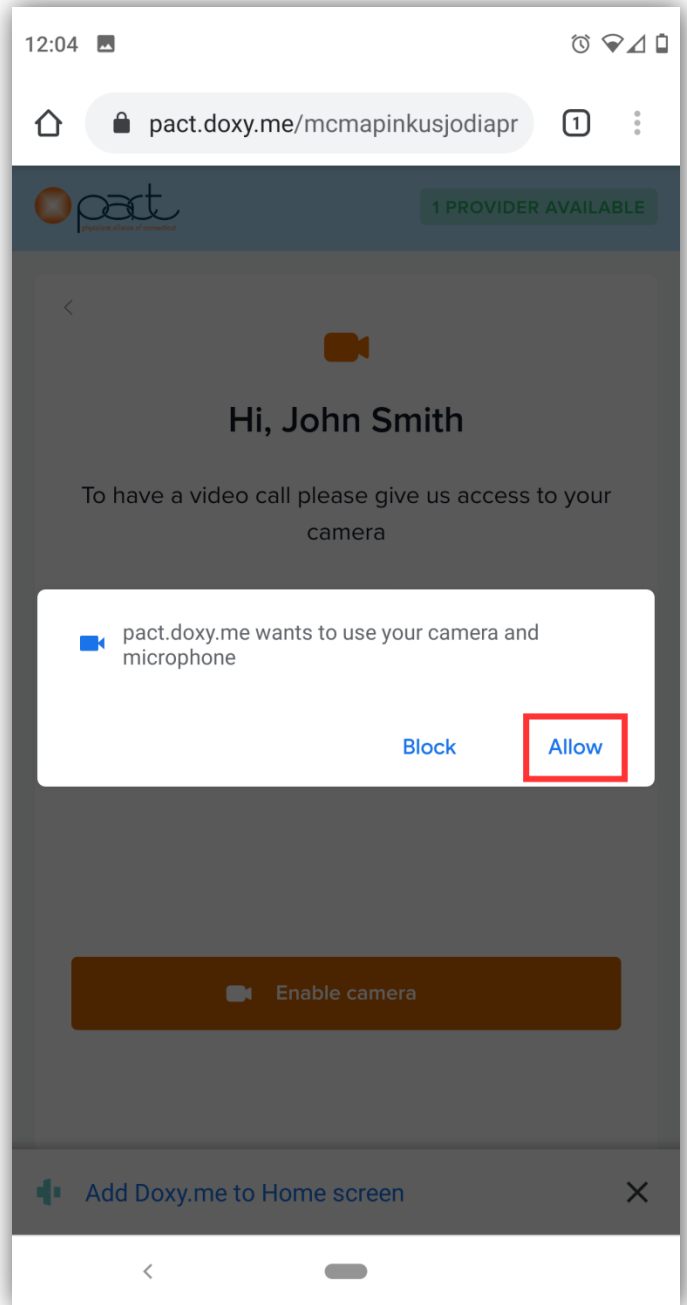
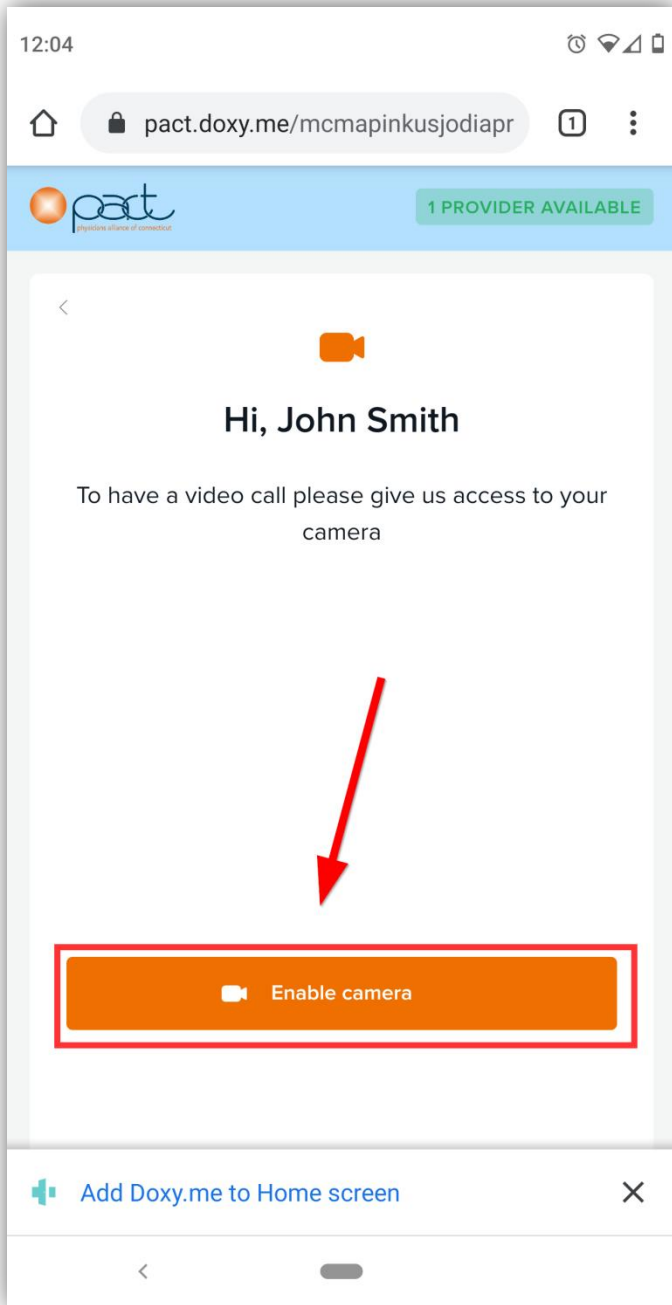

If Chrome asks permission to record video and audio, press 'Allow'

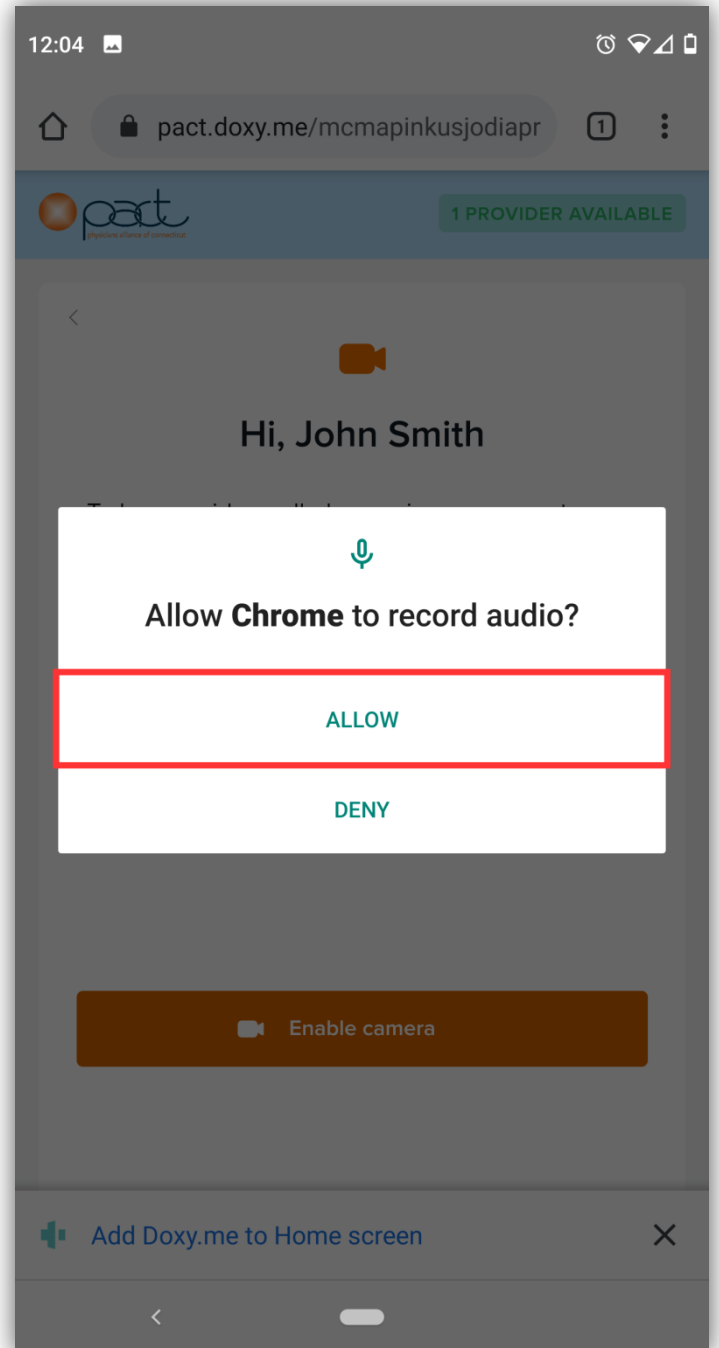
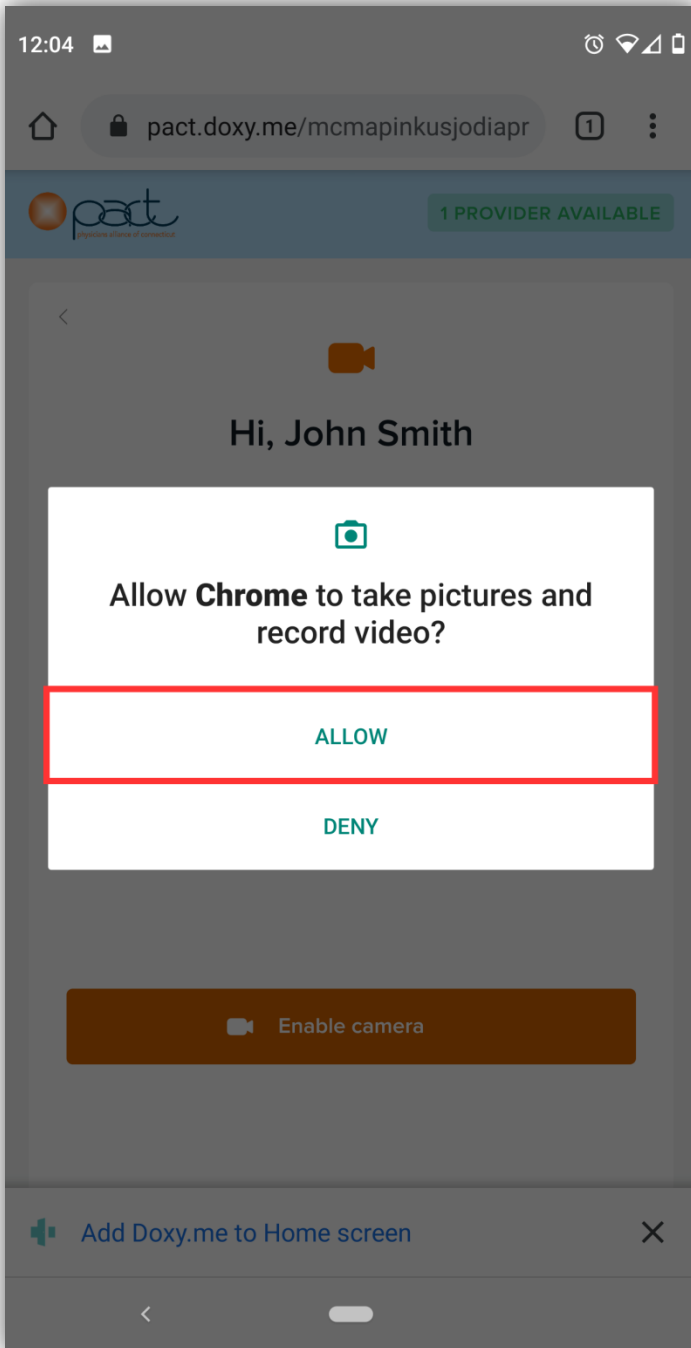

You should now see a preview of your camera and you are ready for your telehealth visit!